

Non penetrating standing seam roof system

Headache-free mounting solution for metal roofs with folded seam design

- Non-penetrating design ensures watertightness.
- Maximum stability with minimum weight.
- Virable combinations with L-feet, fixed foot or PV module clamp directly.
- Simple and quick installation achieved by attaching the clamp to the standing seams.



Locked seam

Location: Singapore

Features

Install site	Suitable for Lysaght® Kliplok®406,700, Lysaght®Locked Seam®, Stratmit® Speed Deck, Fielders® Kingklip, Kalzip® ect, customizable
Min. sheet thickness	0.42mm minimum
Roof slope	Up to 45°
Building height	Up to 20m
Wind speed	Up to 88m/s(316.8kmh/196.9mph)
Standard	AS/NZ1170.2:2011, JIS C 8955:2011, other international standards
Distance between rail fixings	Depending on load condition, refer to manual
PV module	Framed, unframed
Module orientation	Landscape, portrait
Size of module array	Any layout up to site condition
Material	Anodized aluminum 6005 T5, stainless steel 304, 410
Color	Natural, powder coated
Module widths	Maximum 1.0m
Module lengths	Maximum 2.0m
Warranty	10 years limited warranty, refer to warranty doc

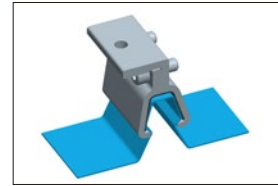

Kliplok®406

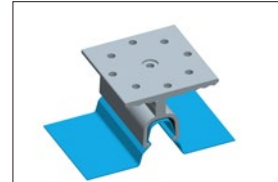

Kliplok®700

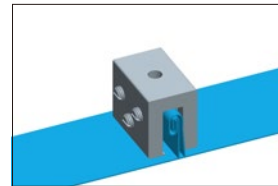

Locked Seam

- Roof structure to be checked as suitable before installation.
Clamps are to be fixed within 100mm of sheet fixing clips to purlins.

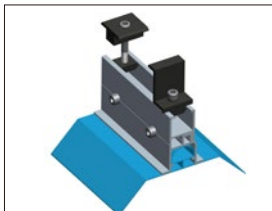

Round seam clamp A

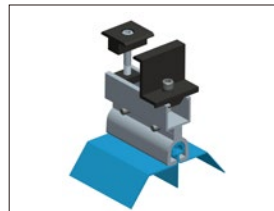

Round seam clamp B

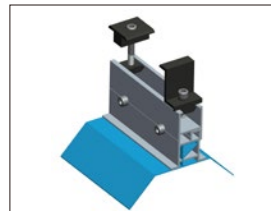

Standing seam clamp



Kalzip®



Standing seam



10
Years
Warranty



Framed module



Unframed module



Orientation landscape



Orientation portrait

